

ZOIDS

SPINEFIN

INSTRUCTIONS

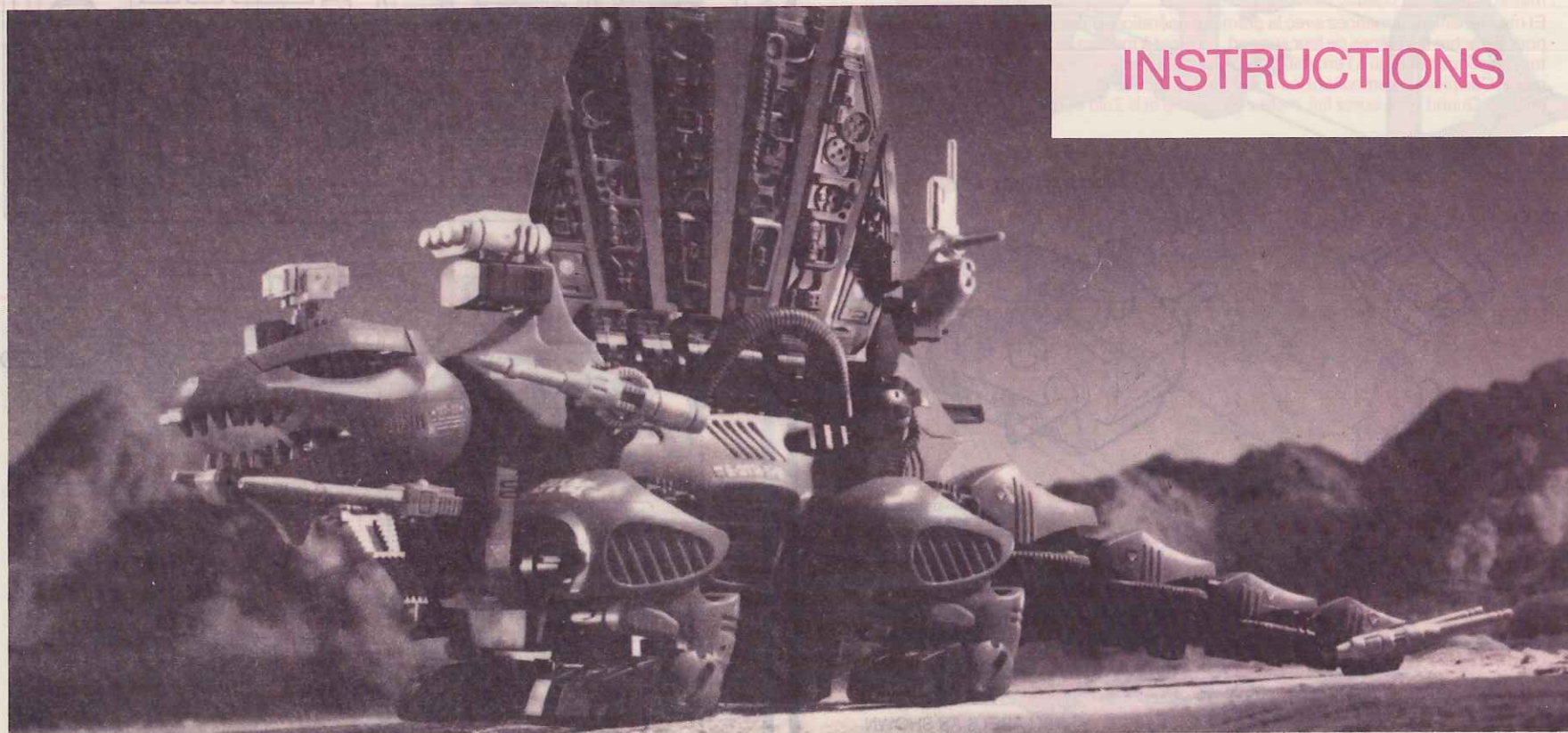

Ref No. 5910

TOMY

BEFORE YOU BEGIN

Do not cut parts off frame before studying each picture thoroughly. Before cutting, match each part number (located on small tabs on the frame) with the corresponding number in each diagram.

Now starting with step 1, use your safety scissors to cut the part off the frame as needed. Remove excess plastic where part was cut from frame. Continue to put your Zoid together part by part. They snap together and do not require glue. When you've finished, switch on and watch the action.

AVANT DE COMMENCER

Ne détachez surtout pas les diverses pièces de leur support avant d'avoir étudié chaque image soigneusement. Avant de couper, identifiez chaque pièce, d'après son numéro (inscrit dans des petites cases sur le support), avec la pièce correspondante ayant le même numéro sur chaque schéma.

Et maintenant, commencez avec la première opération. Utilisez des ciseaux à bout rond pour détacher les pièces de leur support, au fur et à mesure de vos besoins. Enlevez tout plastique superflu à l'endroit où la pièce a été coupée. Montez votre Zoid pièce par pièce. Ces pièces s'emboîtent les unes dans les autres et n'ont pas besoin d'être collées. Quand vous aurez fini, mettez en marche et le Zoid se mettra en mouvement.

HOOD
CAPOT

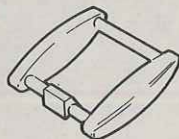

PILOT
PILOTE



CRANK
VILEBREQUIN

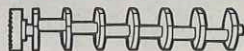

CAPS (12 PIECES)
BOUCHONS (12)

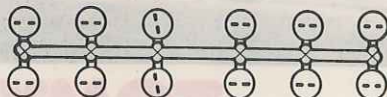

POWER UNIT
MOTEUR

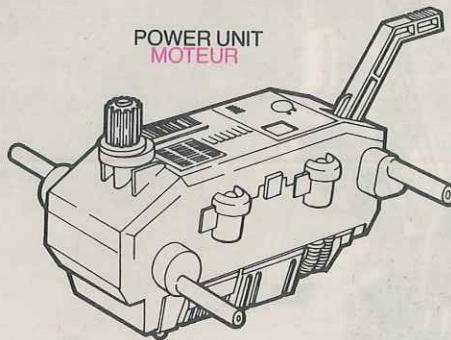

LABEL
ETIQUETTE



AFFIX LABELS AS SHOWN
ON FRONT OF BOX
FIXER LES ETIQUETTES AUX ENDROITS
INDIQUES SUR L'IMAGE SUR
LE DEVANT DE LA BOITE

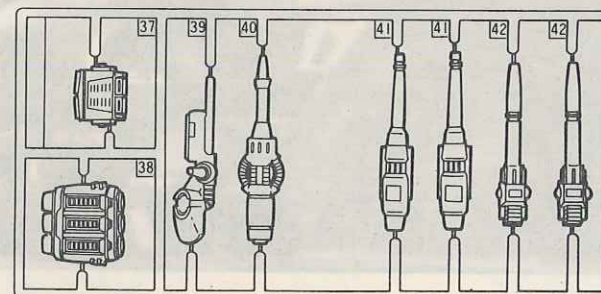
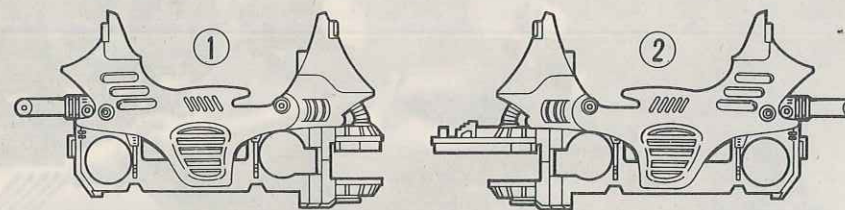
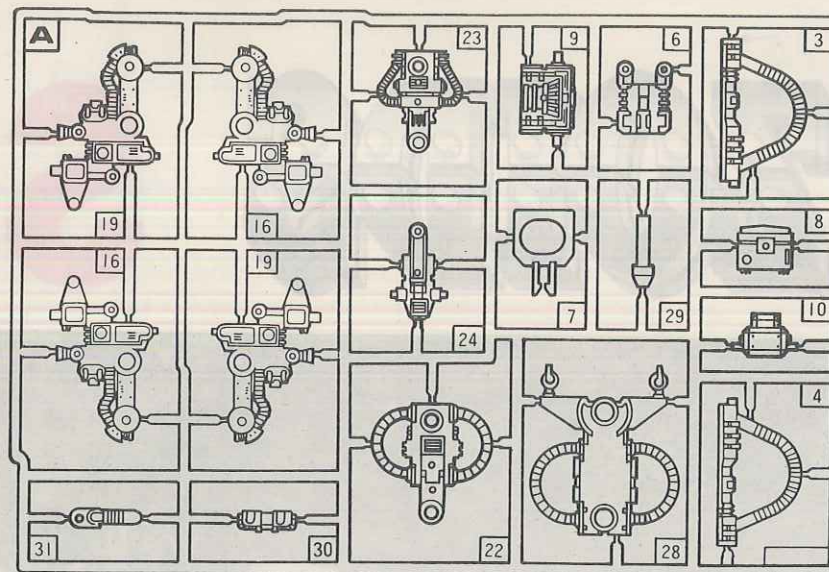

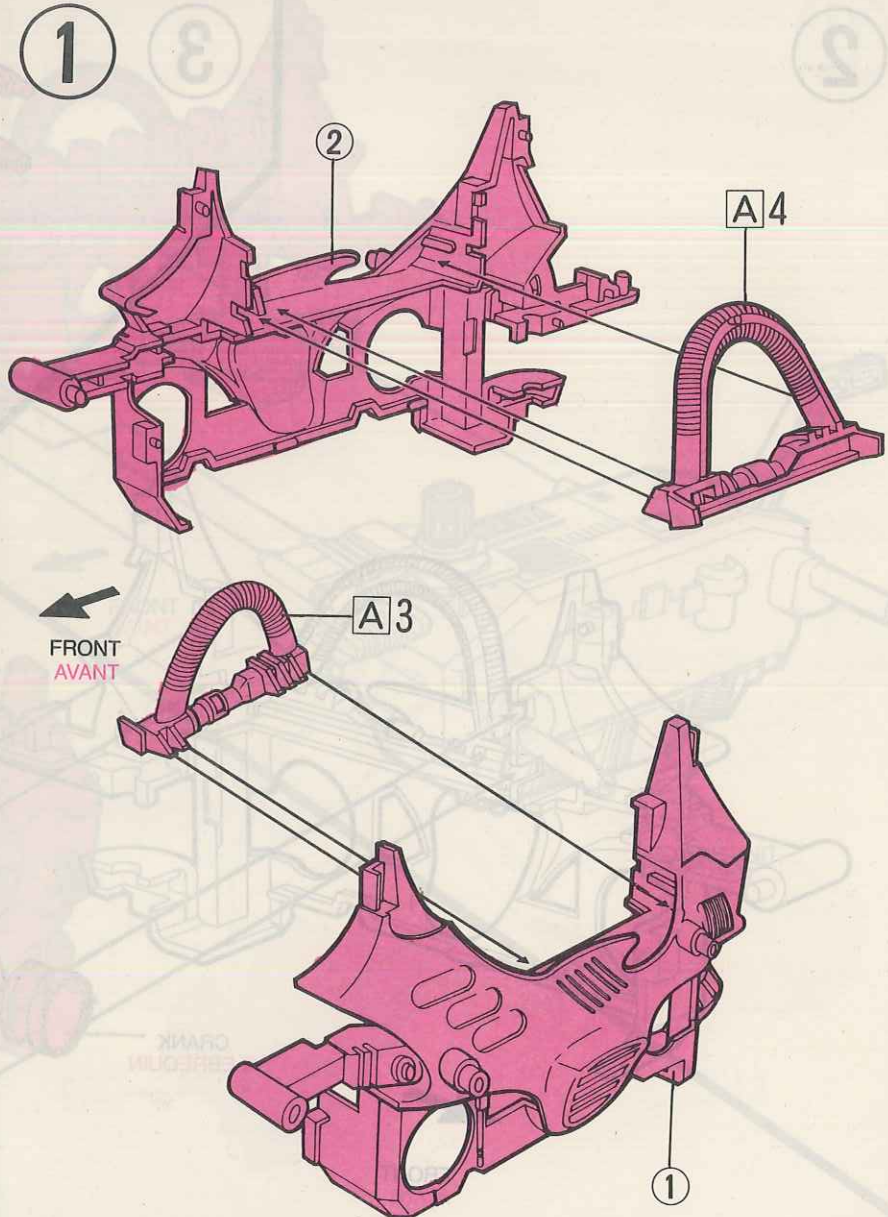
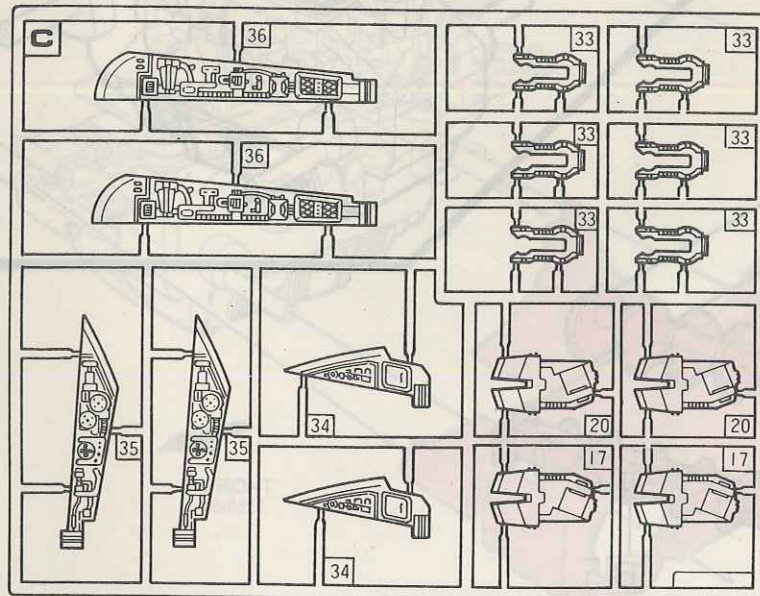
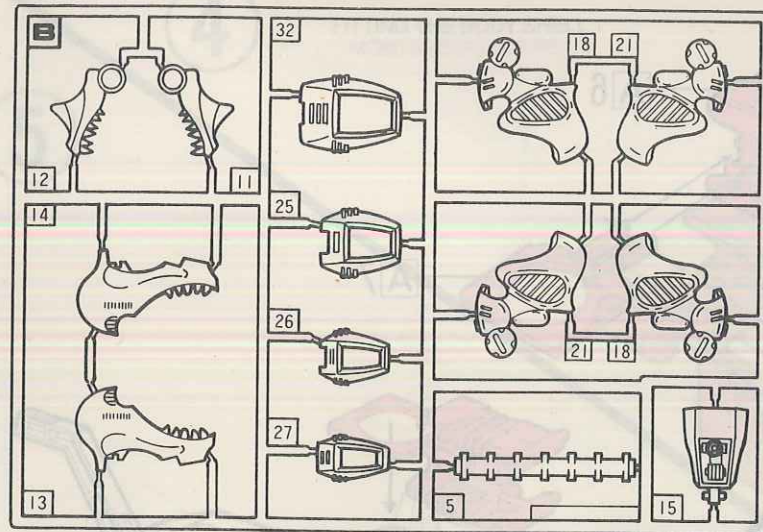

2

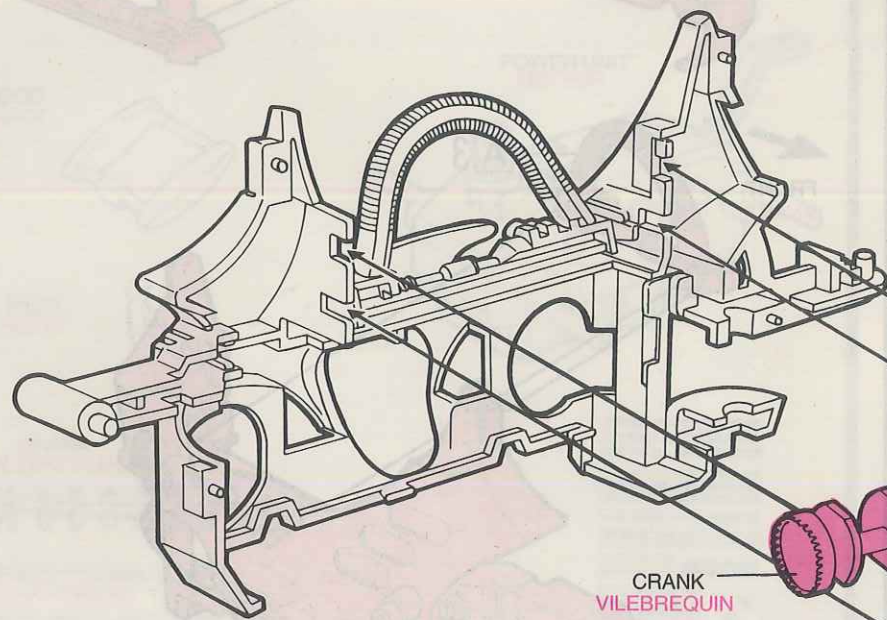

FRONT
AVANT

3

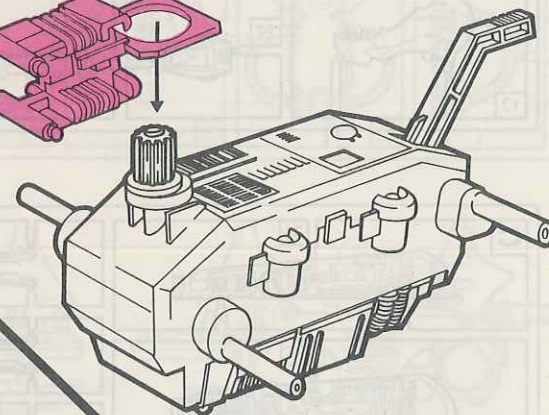
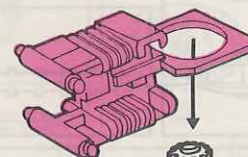
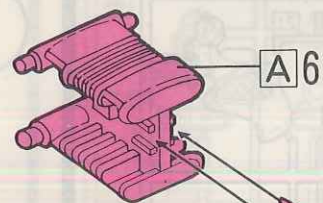

B5

4

FITTING THE BODY SHELL
MONTAGE DU CORPS

5

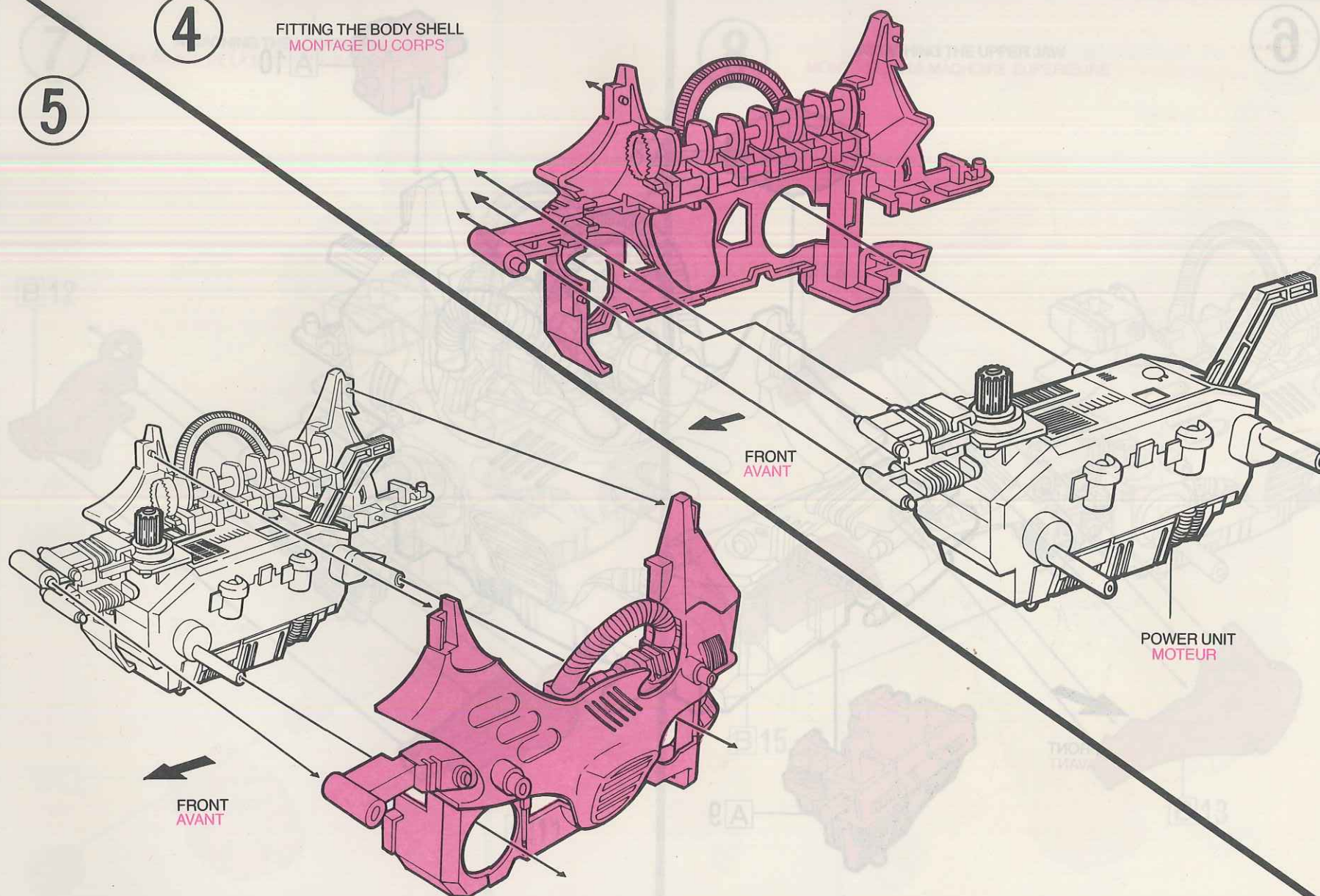

6

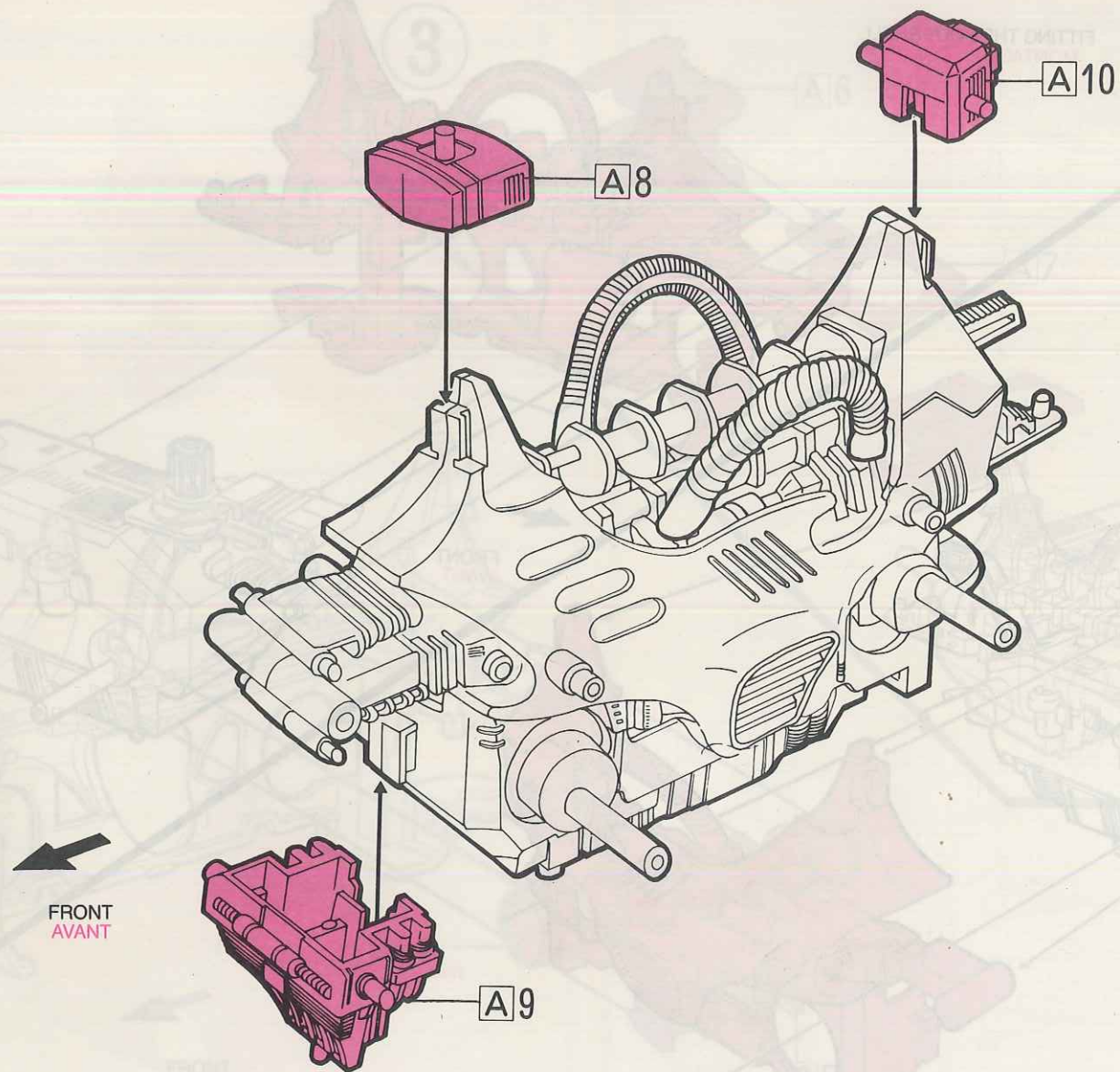

7

ATTACHING THE LOWER JAW
MONTAGE DE LA MÂCHOIRE INFÉRIEURE

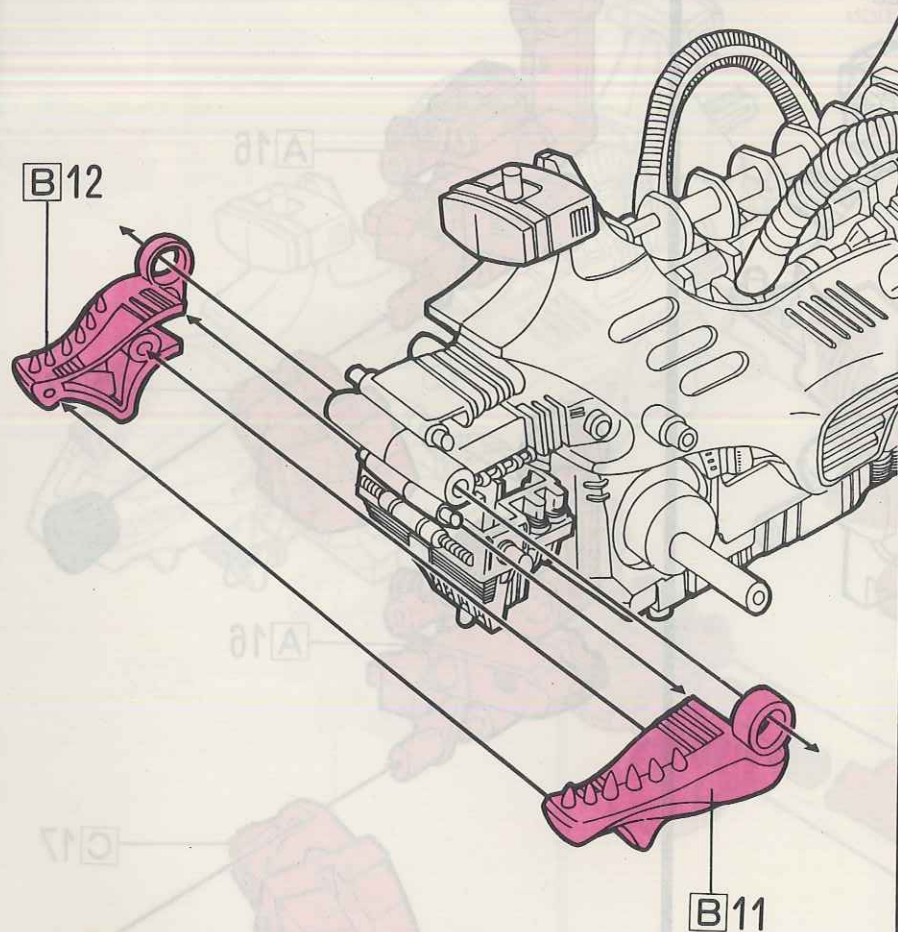

8

ATTACHING THE UPPER JAW
MONTAGE DE LA MÂCHOIRE SUPÉRIEURE

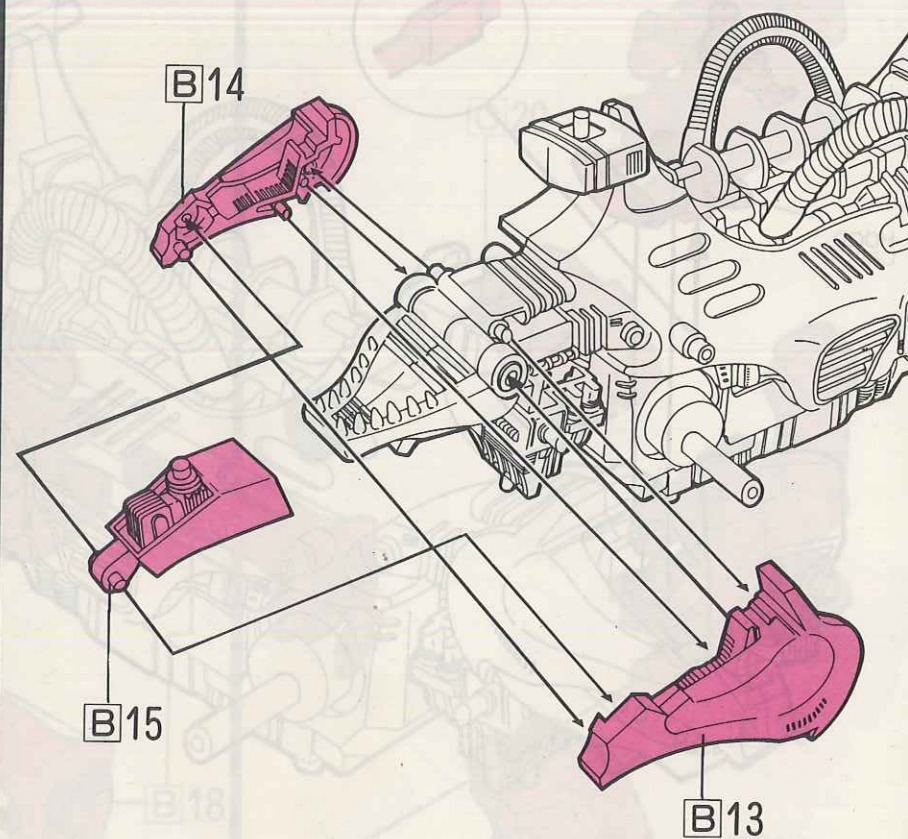

9

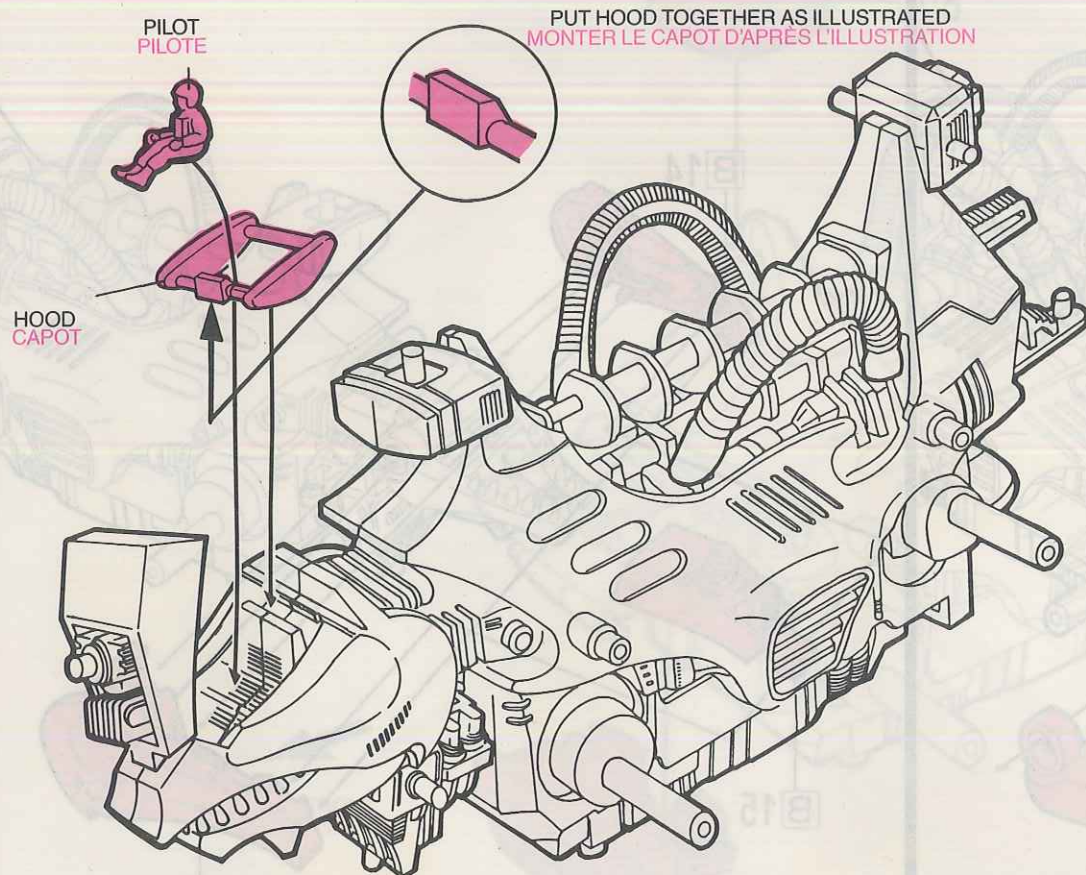

10

ASSEMBLING THE LEFT LEG. CAP
ASSEMBLAGE DE LA JAMBE GAUCHE. BOUCHON

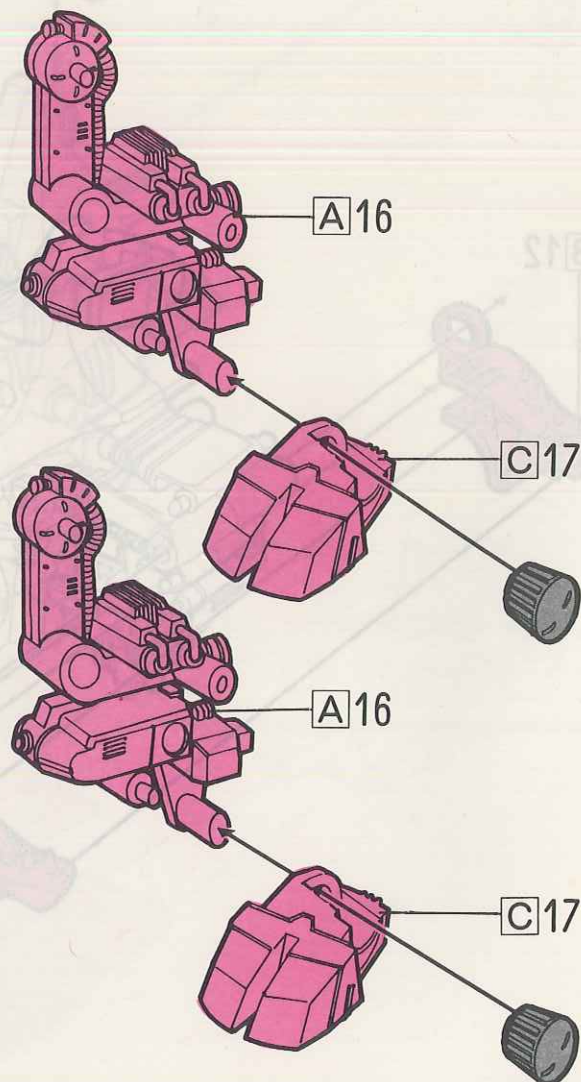

11

ATTACHING THE LEFT LEG
MONTAGE DE LA JAMBE GAUCHE

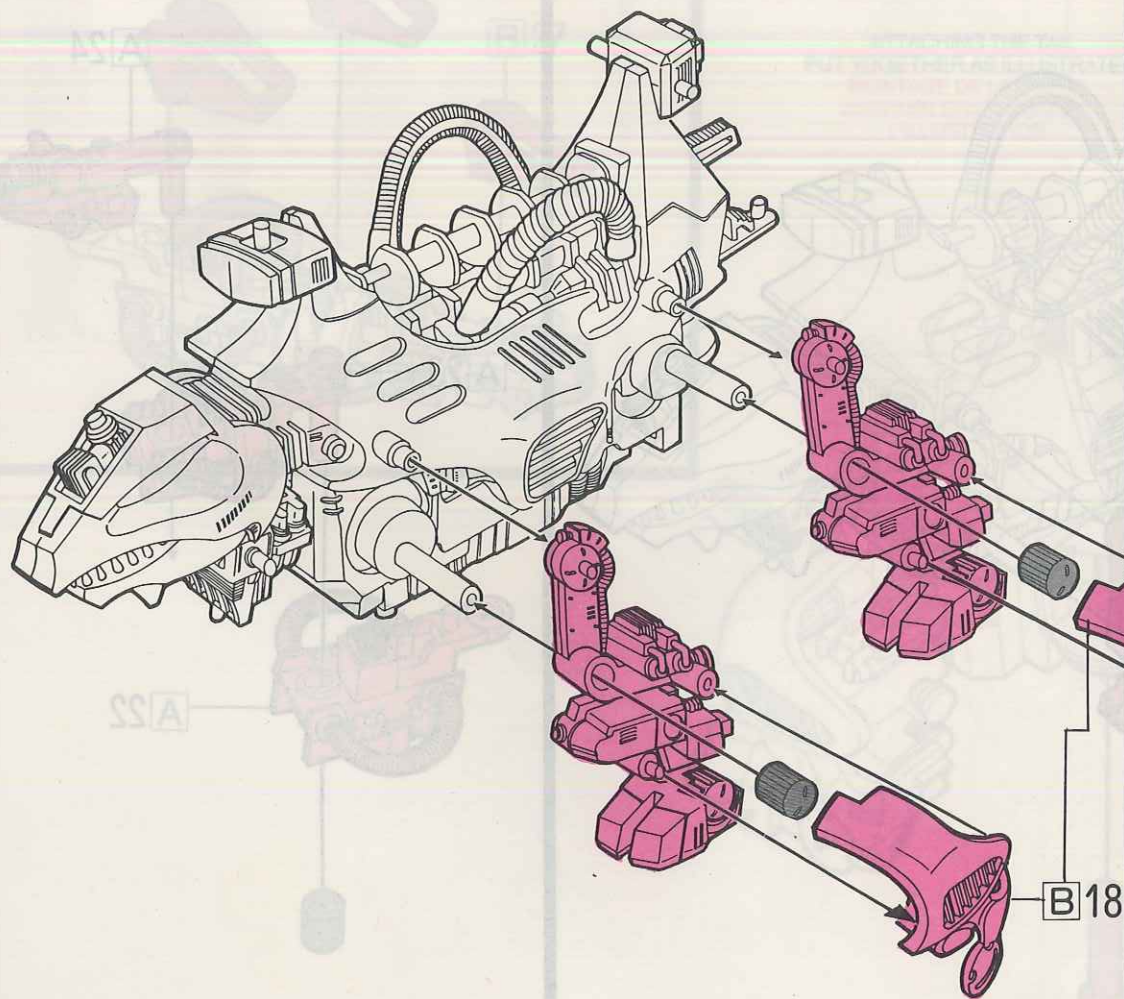

12

ASSEMBLING THE RIGHT LEG
ASSEMBLAGE DE LA JAMBE DROITE

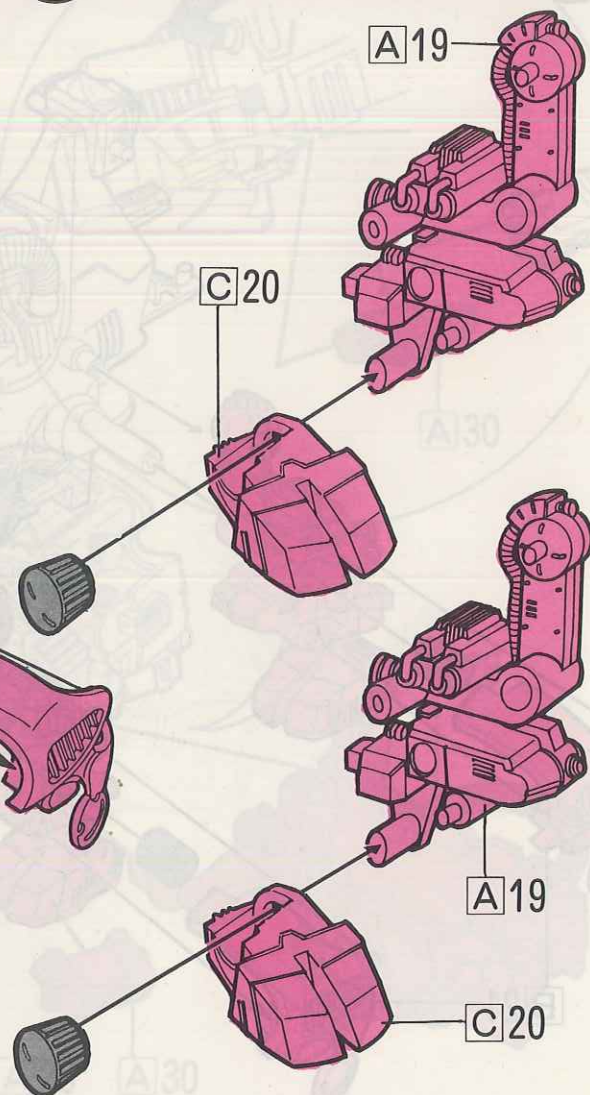

13

ASSEMBLING THE RIGHT LEG
ASSEMBLAGE DE LA JAMBE DROITE

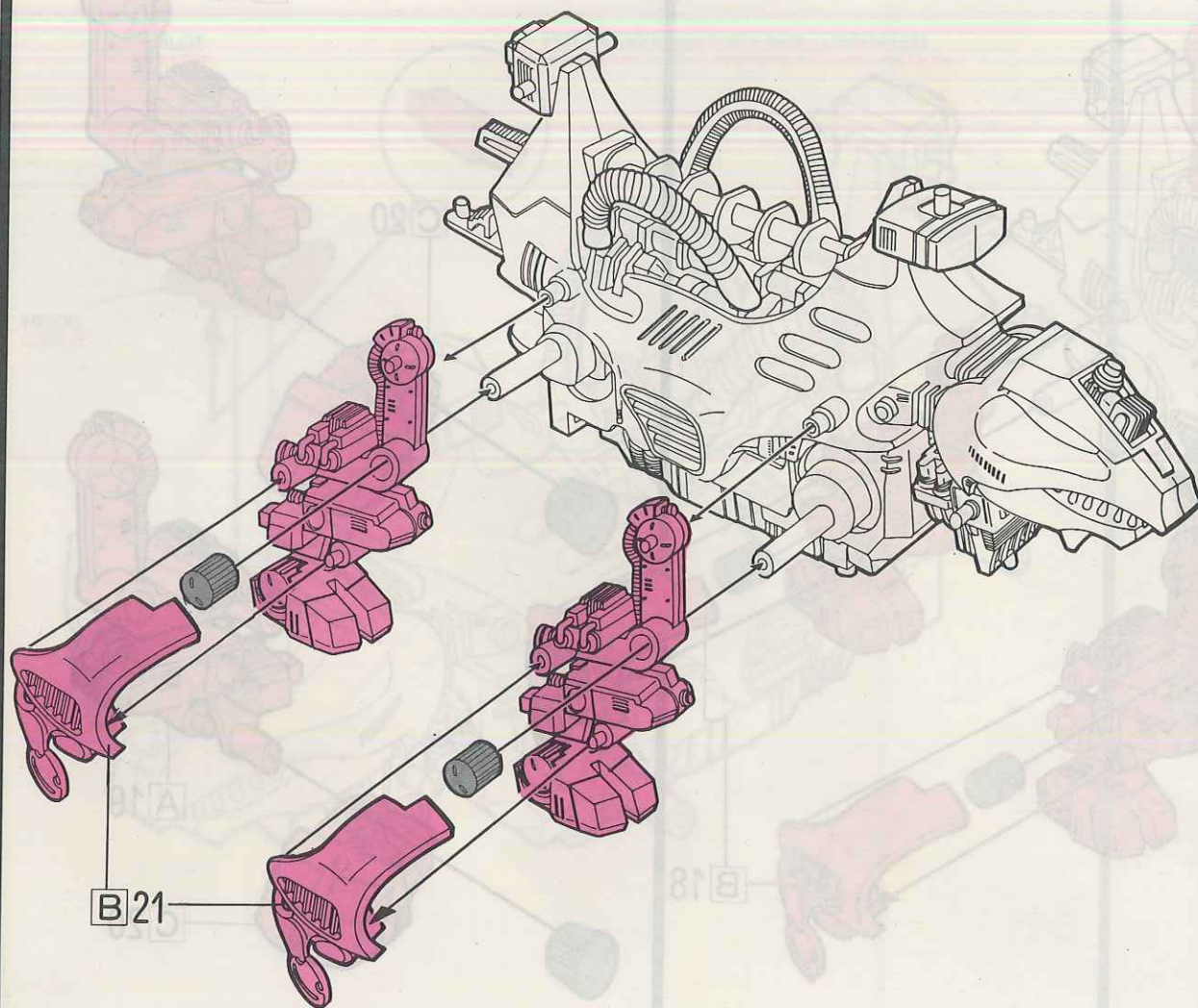

14

ASSEMBLING THE TAIL
ASSEMBLAGE DE LA QUEUE

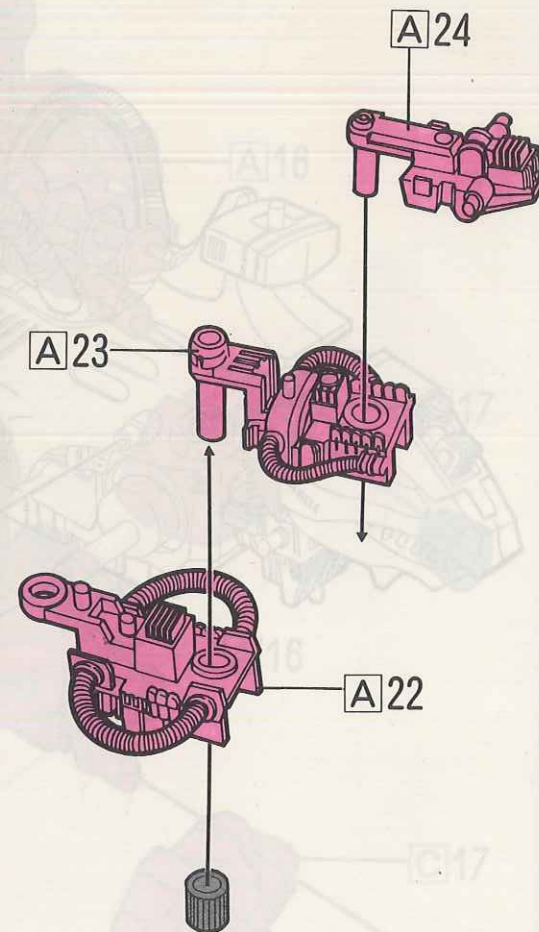

15

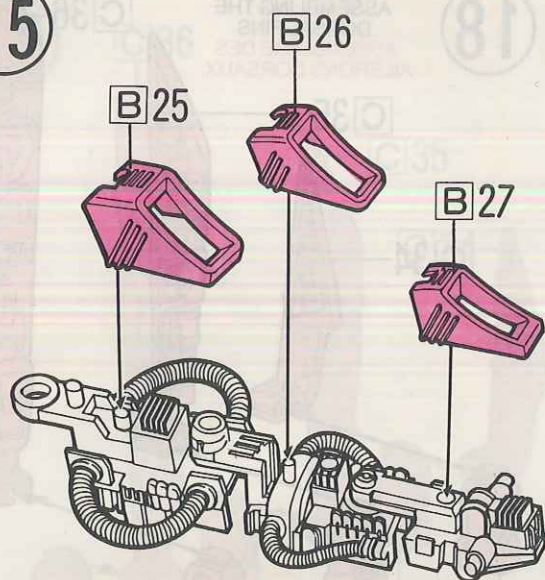

16

ASSEMBLING THE TAIL
ASSEMBLAGE DE LA QUEUE

ATTACHING THE TAIL
PUT TOGETHER AS ILLUSTRATED
MONTAGE DE LA QUEUE
ASSEMBLER EN SUIVANT
L'ILLUSTRATION

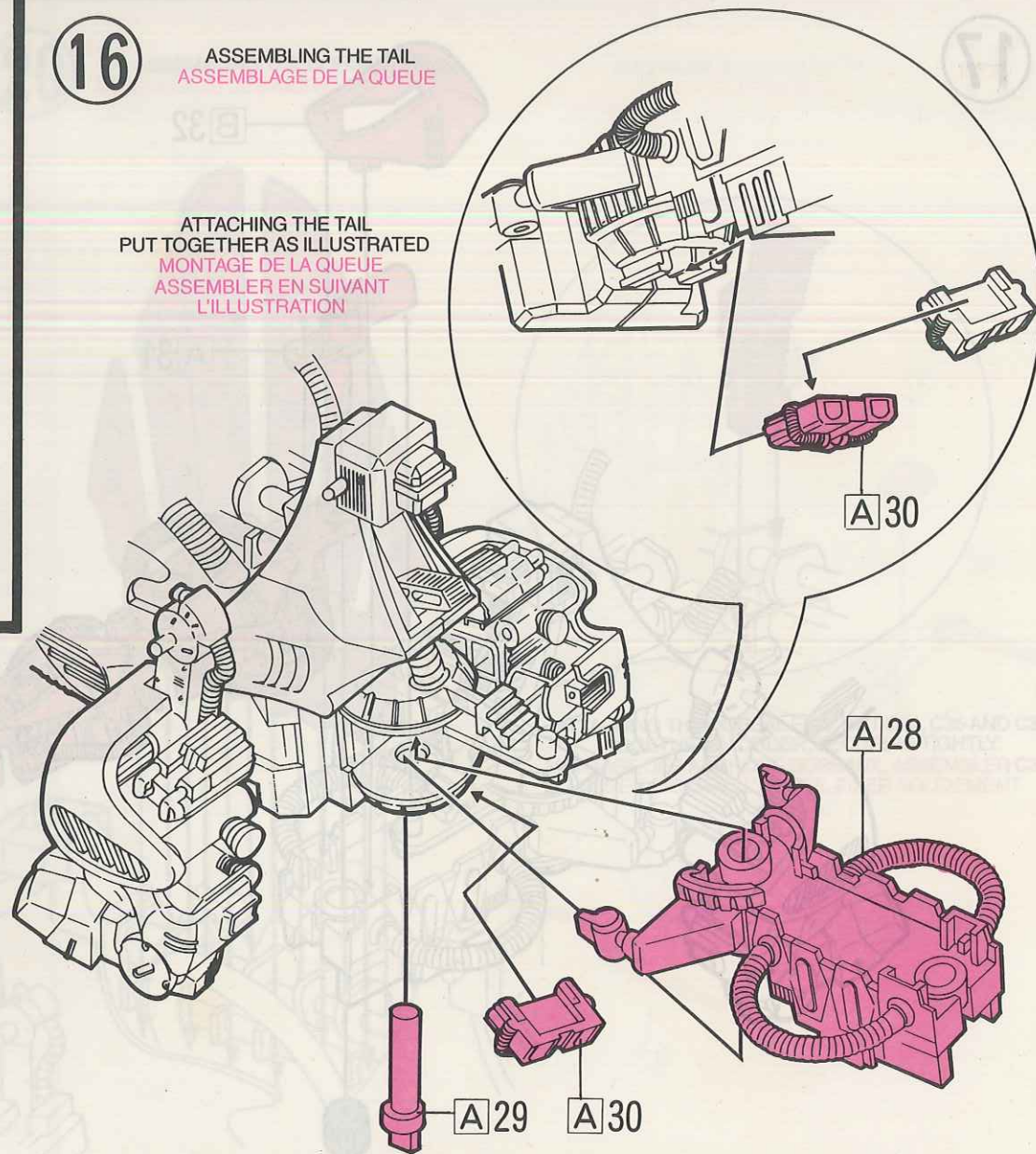

17

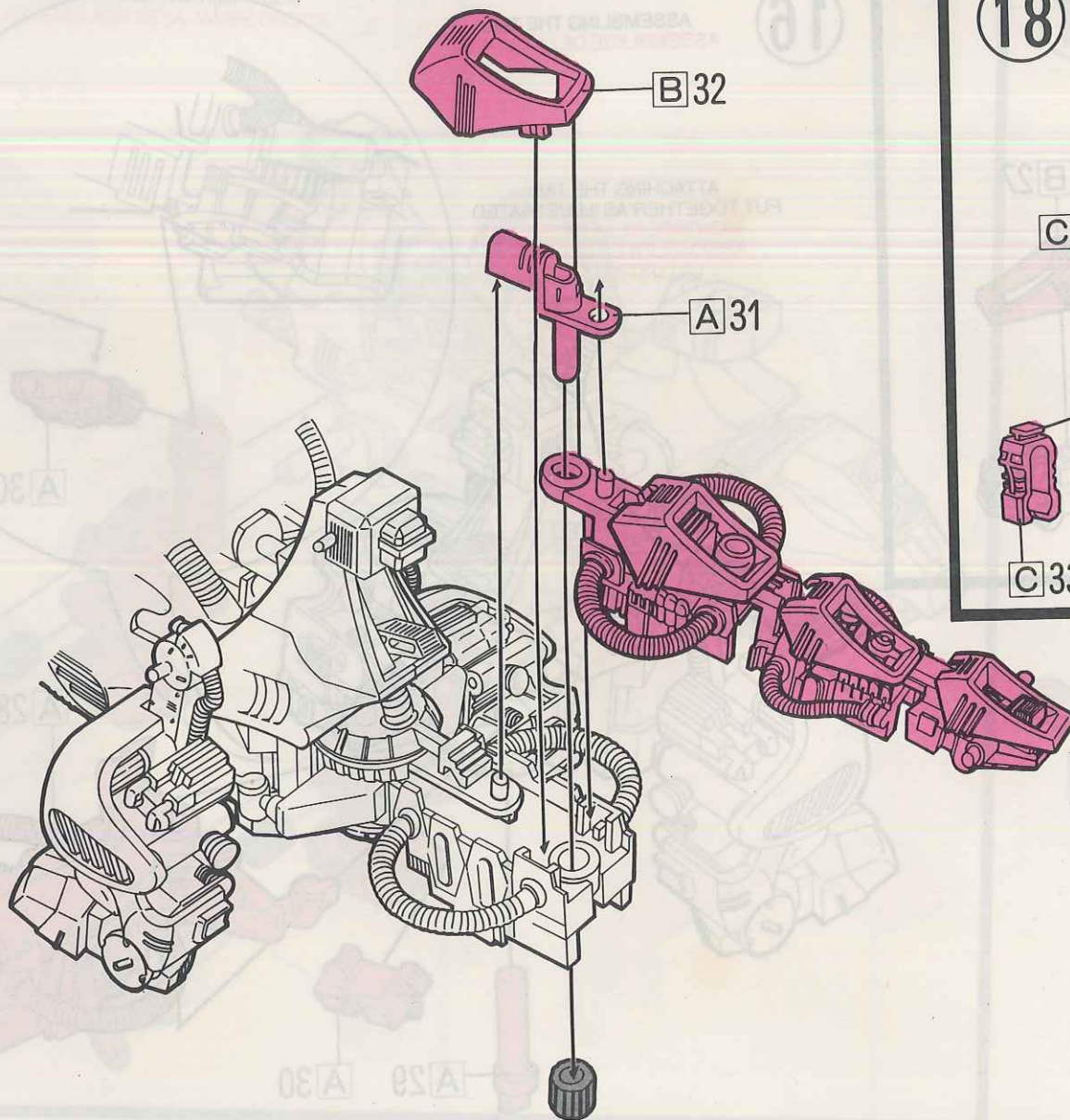

18

ASSEMBLING THE
DORSAL FINS
ASSEMBLAGE DES
AILERONS DORSAUX

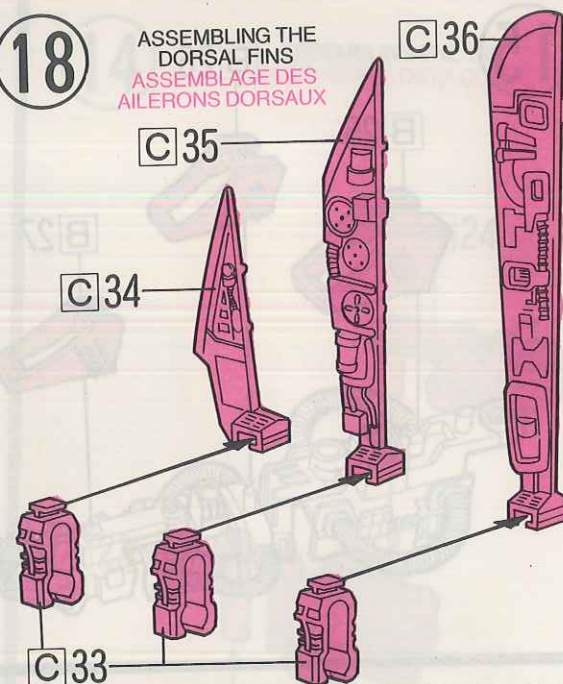

19

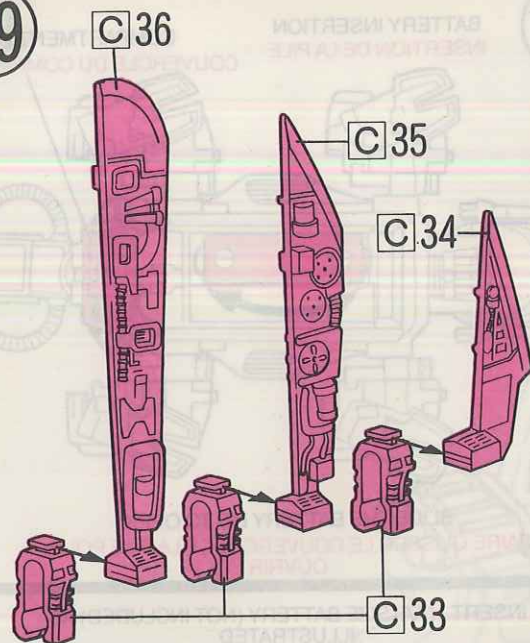

20

ASSEMBLING THE DORSAL FINS
ASSEMBLAGE DES AILERONS DORSAUX

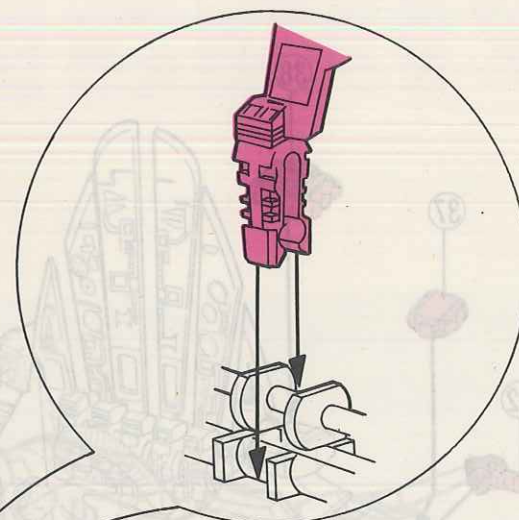
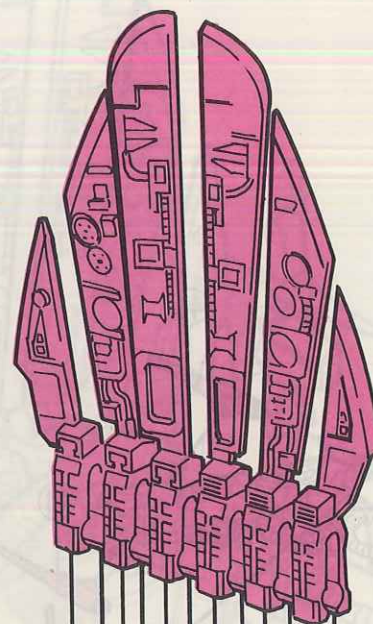

ATTACHING THE DORSAL FINS, PUT C34, C35 AND C36
TOGETHER IN ORDER, SECURING TIGHTLY.
MONTAGE DES AILERONS DORSAUX, ASSEMBLER C34,
C35 ET C36 DANS L'ORDRE, FIXER SOLIDEMENT

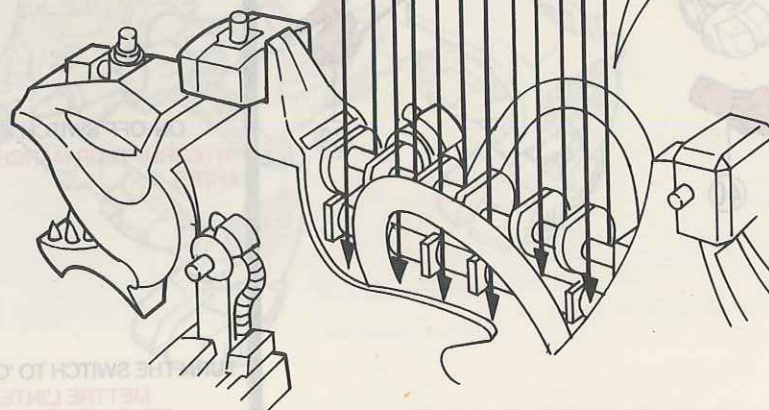

21

ATTACHING THE WEAPONS
ATTACHER LES ARMES

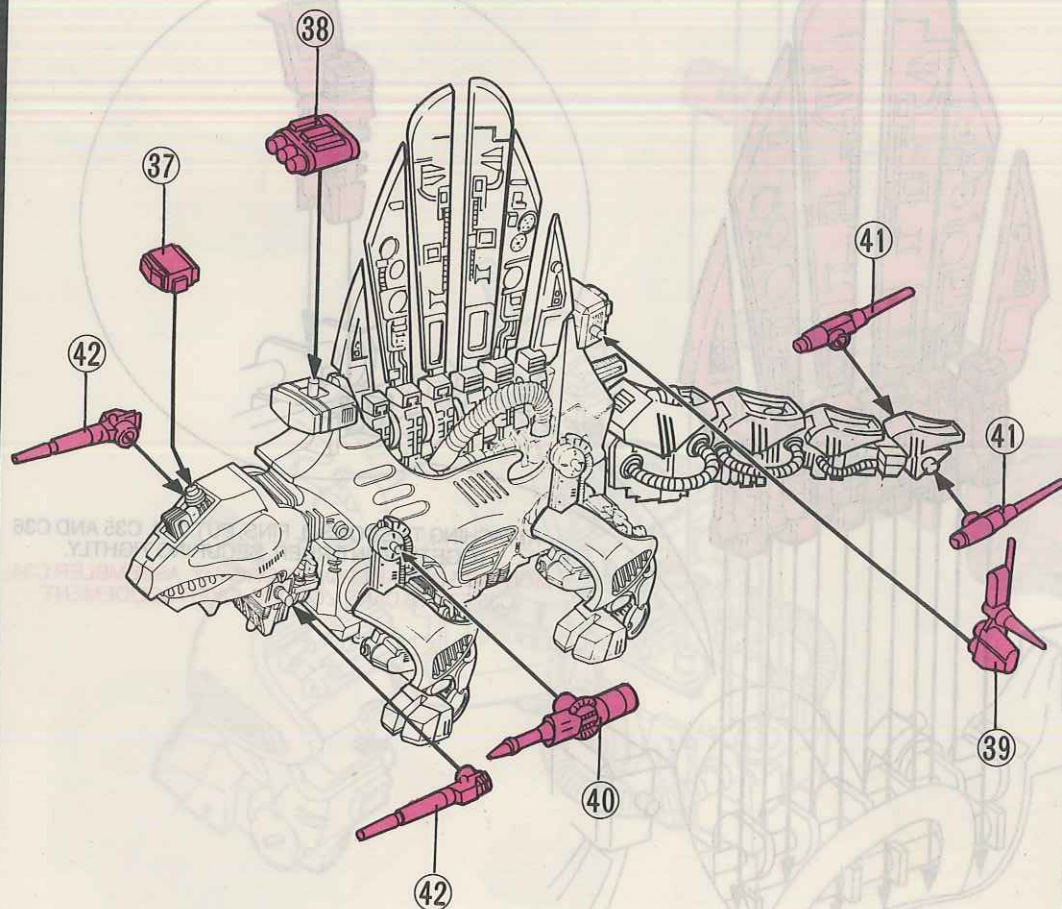

22

BATTERY INSERTION
INSERTION DE LA PILE

COMPARTMENT DOOR
COUVERCLE DU COMPARTIMENT

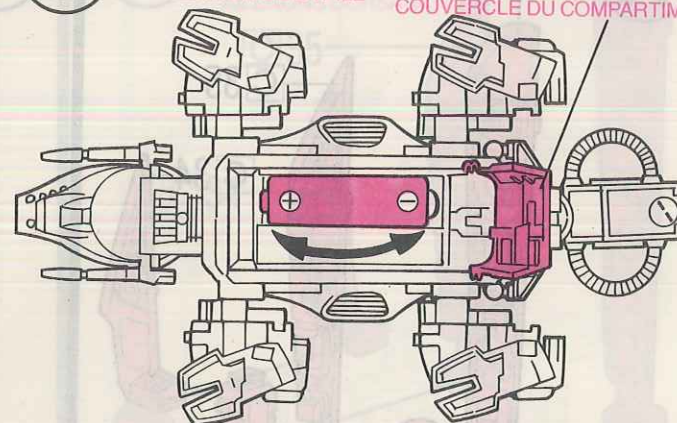

SLIDE THE BATTERY LID TO OPEN
FAIRE GLISSER LE COUVERCLE DE LA PILE POUR OUVRIR

23

INSERT 1(AA) SIZE BATTERY (NOT INCLUDED) AS ILLUSTRATED
INSÉRER 1 PILE AA (NON COMPRISE) (VOIR ILLUSTRATION)

ON-OFF SWITCH
INTERRUPTEUR MARCHÉ/
ARRÊT

ON
MARCHÉ

OFF
ARRÊT

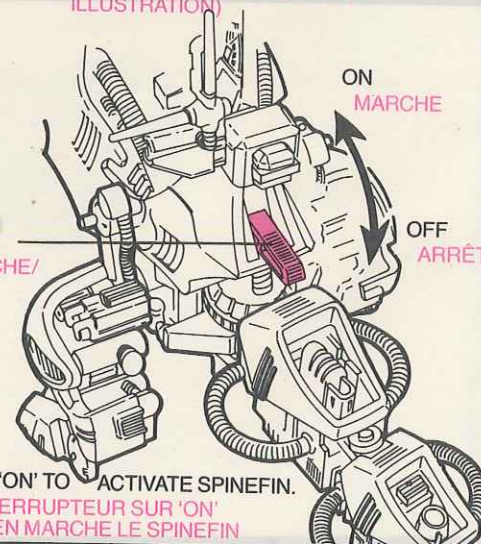

TURN THE SWITCH TO 'ON' TO ACTIVATE SPINEFIN.
METTRE L'INTERRUPTEUR SUR 'ON' POUR METTRE EN MARCHÉ LE SPINEFIN

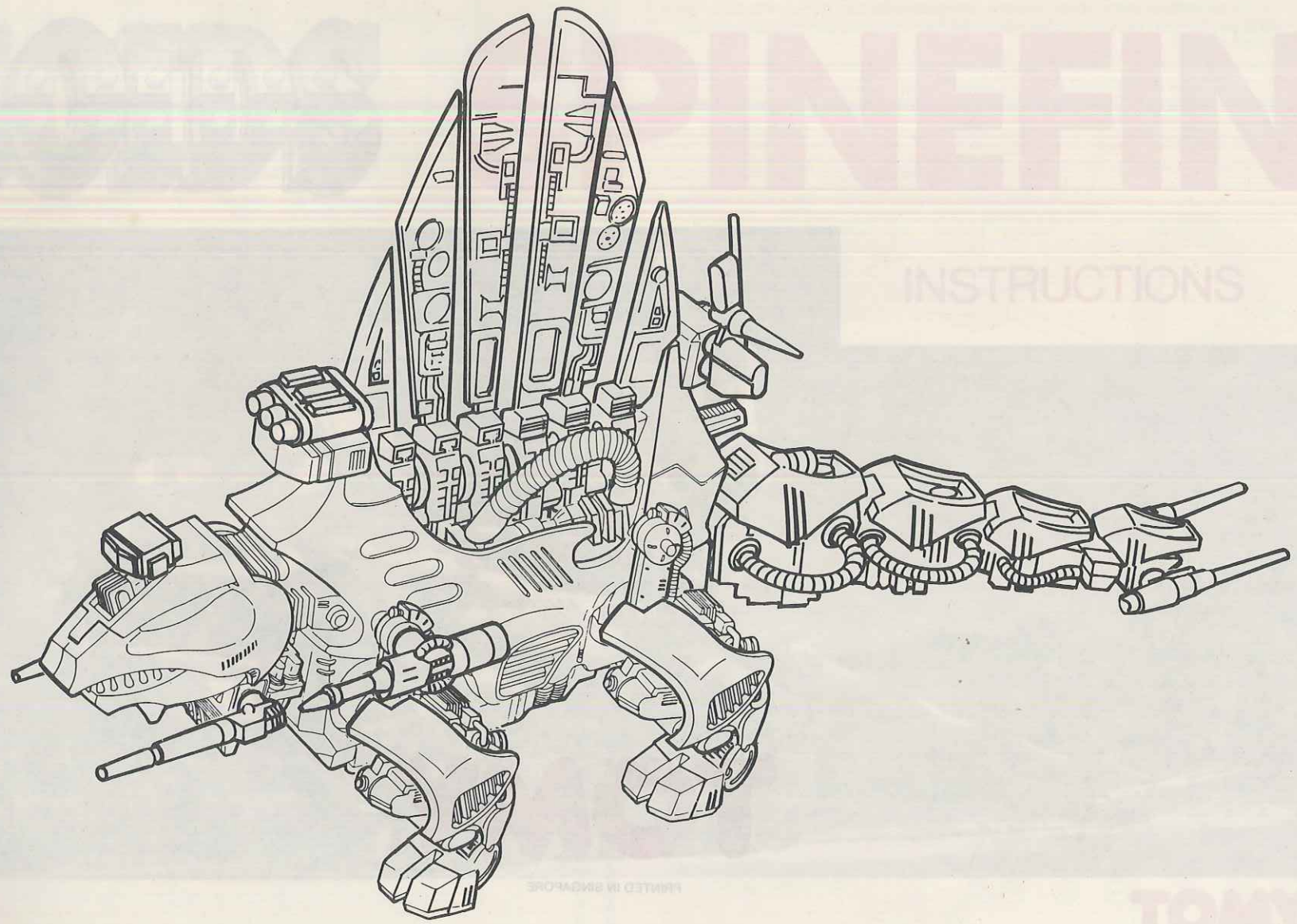

PRINTED IN SINGAPORE

TOMY

21

ATTACHING THE WEAPONS
ATTACHER LES ARMES

22

BATTERY INSERTION
INSERITION DE LA PILE

AS

COMPARTMENT
COMPLÉMENT DU CORPS

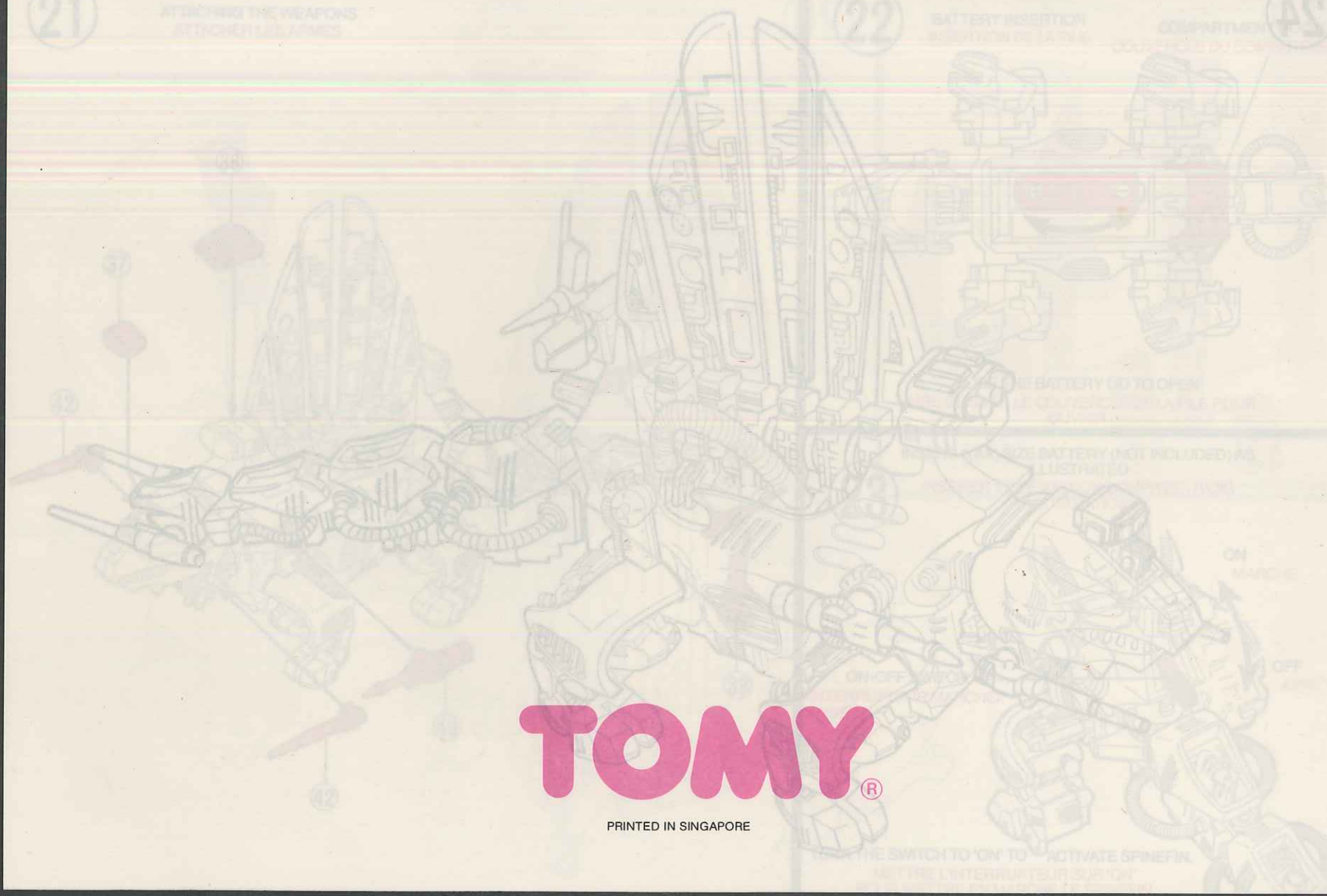

THE BATTERY LID TO OPEN
LE COUVERCLE DE LA PILE POUR
OULVER

SIZE BATTERY (NOT INCLUDED) AS
ILLUSTRATED

ON/OFF SWITCH (PAGE 10)

ON
MARCHÉ

OFF
ARRÊTÉ

TOMY®

PRINTED IN SINGAPORE

THE SWITCH TO 'ON' TO ACTIVATE SPINEFIN
METTRE LE INTERRUPTEUR SUR 'ON'